



<b>Account Information</b>		Order Date: _____	
Account #:	_____	P.O.#	_____
Business Name:	_____	Phone:	_____
Ship to Address:	_____	City:	_____
Fax:	_____	Province:	_____
Contact:	_____	Postal Code:	_____

① FRAME TYPE		
R	<input checked="" type="checkbox"/> Orion II -----	115 <b>\$1,950</b>
A1	<input type="checkbox"/> Power Tilt -----	115MA31 <b>\$1,600</b>

② FRAME FINISH		
	<input type="checkbox"/> Black -----	115C01 No Charge
	<input type="checkbox"/> Silver -----	115C02 No Charge

③ SEAT WIDTH		
	<input type="checkbox"/> 15" Seat Width -----	115SW15 No Charge
	<input type="checkbox"/> 16" Seat Width -----	115SW16 No Charge
	<input type="checkbox"/> 17" Seat Width -----	115SW17 No Charge
	<input type="checkbox"/> 18" Seat Width -----	115SW18 No Charge
	<input type="checkbox"/> 19" Seat Width -----	115SW19 No Charge
	<input type="checkbox"/> 20" Seat Width -----	115SW20 No Charge
A	<input type="checkbox"/> 21" Seat Width (Weight Limit 350 lbs.)-----	115SW21HD1 \$475
A	<input type="checkbox"/> 22" Seat Width (Weight Limit 350 lbs.)-----	115SW22HD1 \$475
A,B	<input type="checkbox"/> 23" Seat Width (Weight Limit 350 lbs.)-----	115SW23HD1 \$685
A,B	<input type="checkbox"/> 24" Seat Width (Weight Limit 350 lbs.)-----	115SW24HD1 \$685

④ SEAT DEPTH		
	<input type="checkbox"/> 15" Seat Depth -----	115SD15 No Charge
	<input type="checkbox"/> 16" Seat Depth -----	115SD16 No Charge
	<input type="checkbox"/> 17" Seat Depth -----	115SD17 No Charge
	<input type="checkbox"/> 18" Seat Depth -----	115SD18 No Charge
	<input type="checkbox"/> 19" Seat Depth -----	115SD19 No Charge
	<input type="checkbox"/> 20" Seat Depth -----	115SD20 \$110
	<input type="checkbox"/> 21" Seat Depth -----	115SD21 \$225
	<input type="checkbox"/> 22" Seat Depth -----	115SD22 \$225
	<input type="checkbox"/> 23" Seat Depth -----	115SD23 \$225
	<input type="checkbox"/> 24" Seat Depth -----	115SD24 \$225
T	<input type="checkbox"/> EZ Tilt Option -----	115AL4 No Charge

- Standard Features:**
- Seat Width 18"
  - Seat Depth 18"
  - Canes and Stroller Bar
  - T-Style Height Adjustable Full Length Gel
  - Seat to Floor 18"
  - Rear Wheels 24"
  - Casters 8"
  - Multi Adjustable Axle Plate
  - 70 Degree Front Rigging w/aluminum flip up footplate
  - Heel Loops
  - Push to Lock Wheel Locks
  - Aluminum Seat Pan
  - Prism Ideal Cushion
  - Adjustable Orion Back
  - Two way Padded, Contoured Headrest
  - Anti-tippers
  - Choice of 2 colors - Black or Silver



**MEDmobility**  
5711- Calgary Trail NW  
Edmonton AB T6H 2K1  
P: 780-437-3300  
F: 780-430-9381  
www.medmobility.ca

A1 = Clients Responsibility  
A2 = Clinical Justification

- FOOTNOTES:**
- A. Heavy Duty Package consisting of gusseted frame
  - B. Quick release axles are used on 23"-24" wide chairs.
  - R. Add 9.5" to seat width of chair on finished product (handrim to handrim)
  - T. EZ Tilt option recommended on seat depths of 20" or higher

**ORION II FRONT SEAT TO FLOOR HEIGHT MATRIX**

FRONT STF	CASTER	FORK HOLE	STEM LENGTH
13.25	4"	1	X-SHORT
14.5	5"	1	SHORT
15.0	5"	2	SHORT
15.5	5"	3	SHORT
16.0	6"	3	SHORT
16.5	7"	3	SHORT
16.0	5"	3	LONG
16.5	6"	3	LONG
17.0	7"	3	LONG
17.0	8"	3	LONG
18.0	8"	4	LONG
19.0	8"	4	LONG
20.0	8"	4	LONG

\*  
\*\*

\* 1" RISER BLOCK REQUIRED  
\*\* 2" RISER BLOCK REQUIRED



1  
CASTER FORK  
X-SHORT

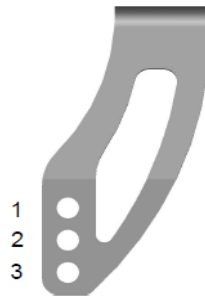

1  
2  
3  
CASTER FORK  
SHORT

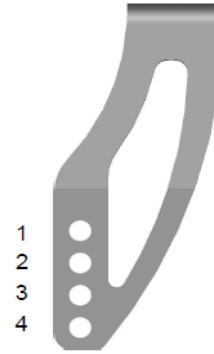

1  
2  
3  
4  
CASTER FORK  
LONG

**⑤ SEAT-TO-FLOOR HEIGHT (up to 350 lbs. weight capacity) - Orion II**

- 13.25" Seat to Floor (20" Wheels and 4" Casters) 115STF01 \$225
- 14.5" Seat to Floor (20" rear and 5" casters) 115STF02 No Charge
- 15" Seat to Floor (20" Wheels and 5" Casters) 115STF03 No Charge
- 15.5" Seat to Floor (22" Wheels and 5" Casters) 115STF25 No Charge
- 15.5" Seat to Floor (12" Wheels and 6" Casters) 115STF26 \$195
- 16" Seat to Floor (20" Wheels and 5" Casters) 115STF27 No Charge
- 16" Seat to Floor (12" Wheels and 6" Casters) 115STF28 \$195
- 16" Seat to Floor (24" Wheels and 6" Casters) 115STF29 No Charge
- 16" Seat to Floor (22" Wheels and 6" Casters) 115STF06 No Charge
- 16 1/2" Seat to Floor (24" Wheels and 6" Casters) 115STF30 No Charge
- 16 1/2" Seat to Floor (24" Wheels and 7" Casters) 115STF31 No Charge
- 16 1/2" Seat to Floor (22" Wheels and 7" Casters) 115STF08 No Charge
- 17" Seat to Floor (24" Wheels and 7" Casters) 115STF32 No Charge
- 17" Seat to Floor (22" Wheels and 8" Casters) 115STF33 No Charge
- 18" Seat to Floor (24" Wheels and 8" Casters) 115STF11 Standard
- 19" Seat to Floor (24" Wheels and 8" Casters) 1" Spacer 115STF34 No Charge
- 20" Seat to Floor (24" Wheels and 8" Casters) 2" Spacer 115STF35 \$110

SUPER LOW

FRONT STF	REAR WHEEL	AXEL POS. SUPERLOW
13.25	20"	1
13.25	16"	2
14.5	20"	1
14.5	16"	3
15.0	20"	2
15.5	22"	1
15.5	12"	4
16.0	24"	1
16.0	22"	2
16.0	20"	3
16.0	12"	4
16.5	24"	1
16.5	22"	2
16.5	24"	1
16.5	24"	1
17.0	24"	2
17.0	22"	3
18.0	16"	4
18.0	24"	3
19.0	24"	3
20.0	24"	3

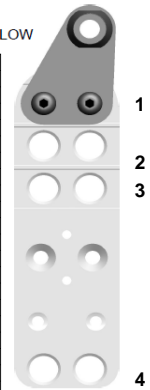

\* 1" RISER BLOCK REQUIRED  
\*\* 2" RISER BLOCK REQUIRED

AXEL POSITIONS

**⑥ REAR WHEEL RIM**

- Mag Wheels 115RW09 No Charge

C. Only available with pull to lock brakes.

**⑦ REAR WHEEL TIRE**

- Airless (Solid Rubber) 115RT1 Standard
- Pneumatic 115RT2 No Charge

D. With 12" rear wheel you can only have push to lock brakes.

**⑧ HANDRIM OPTIONS**

- Chrome 115HR1 Standard
- Plastic Coated 115HR2 \$160
- Omit Handrims 115HR3 less net \$15

A1 = Clients Responsibility

A2 = Clinical Justification

**(9) ARM TYPE**

- T-Style Adjustable Height ----- 115AR04 Standard
- Flip Back Adjustable Height ----- 115AR10 No Charge
- T-Style Adjustable Height Pin Release - Youth ----- 115AR05 \$125
- T-Style Adjustable Height Pin Release - Adult ----- 115AR06 \$125
- T-Style Fixed Height ----- 115AR02 \$125
- 2-point Fixed Height Heavy Duty Arm ----- 115AR13 \$125

Armrest Matrix for T-Style Pin Release Arm						
Armrest Style	Transfer Tube	Arm Guard	H Range	Arm Pad Length L		
	Length D1	Length D2		Desk	Full	Curved
Adult	6.75"	7.50"	9.50" - 14.50"	10.25"	14.0"	17.0"
Youth	4.50"	5.0"	8.75" - 13.75"			

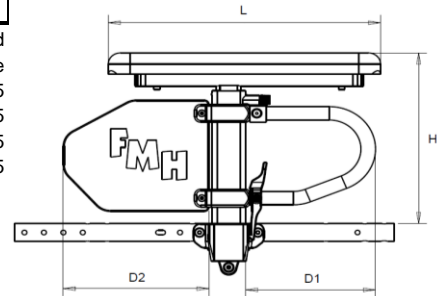

**(10) ARM PAD**

- Desk length Vinyl 10" (pair)----- 115AP1 No Charge
- Full length Vinyl 14" (pair)----- 115AP2 No Charge
- Contour Gel 17" (pair)----- 115AP3 Standard

**(11) PUSH OPTIONS**

- Canes & Stroller Bars Fixed High ----- 115SP2 No Charge
- Canes & Stroller Bars Fixed Low ----- 115SP1 No Charge
- Canes & Stroller Bars Fold Down High ----- 115SP4 \$250
- Canes & Stroller Bars Fold Down Low ----- 115SP3 \$250
- Stroller Bars Fixed High----- 115SH2 No Charge
- Stroller Bars Fixed Low----- 115SH1 No Charge
- Stroller Bars Adjustable Angle Fold Down High----- 115SH4 \$250
- Stroller Bars Adjustable Angle Fold Down Low----- 115SH3 \$250
- Canes & Stroller Bars Recline High----- 115SP6 \$500
- Canes & Stroller Bars Recline Low----- 115SP5 \$500
- Stroller Bar Recline High----- 115SP12 \$500
- Stroller Bar Recline Low----- 115SP11 \$500
- Back Cane Angle (83, 90, 97, 104,111) Specify \_\_\_\_\_ 115BA1 No Charge

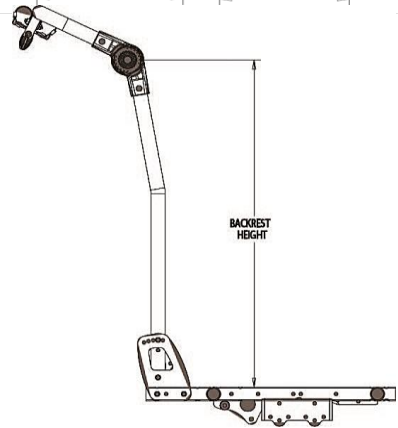

**(12) TRIGGER LOCATION**

- Trigger Location - Push Cane----- 115TH1 No Charge
- Trigger Location - Stroller Bar----- 115TH2 No Charge
- A1  Foot Tilt Release (Mounted onto left side) ----- 115TH3 \$95
- A1  Foot Tilt Release (Mounted onto right side) ----- 115TH4 \$95

**(13) BACK OPTIONS (CHOOSE ONE)**

- E  Orion Back (16", 18", 20") available height only----- 115BK00 No Charge
- Omit Back ----- 115BK49 less net \$30
- Prism Basic Back ----- 115BK01 \$150

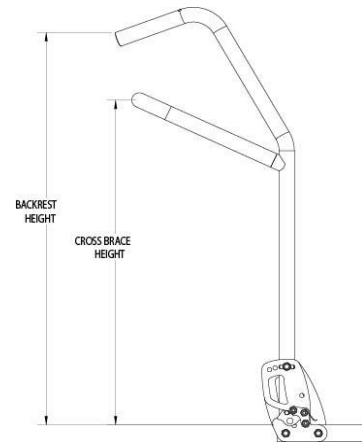

**(14) BACK PINS**

- s  Longer Pins for Back Hardware 1" Growth ----- 115BP1 \$50
- s  Longer Pins for Back Hardware 2" Growth ----- 115BP2 \$50

**(15) SEAT OPTIONS (CHOOSE ONE)**

- Seat Pan ----- 115SE1 Standard
- Prism Ideal Cushion - Stock Sizes ----- 115SC01 Standard
- Prism Ideal Cushion - Non-Stock Sizes ----- 115SC02 No Charge
- Prism Ideal Cushion Custom on chair----- 115SC03 No Charge
- Omit Cushion ----- 115SC20 less net \$10

A1 = Clients Responsibility  
A2 = Clinical Justification

**FOOTNOTES:**

- E. Height adjustability of 4" and depth adjustability of 1"
- F. Max Backs come in one of the following colours: Black, Navy Blue, Royal Blue, Forest Green or Burgundy
- G. Please refer to Backs order form for stock, non-stock, bariatric and custom sizes
- H. Includes Swingway Calf Pads
- I. Not available with 7" or 8" casters when footboard is facing back on 90 degree swingaway

J. Swingaway Calf Pad can only be assembled onto Swingaway front rigging.

S. Pins not required for Lunar Backs

**FOOTNOTES:**

Mounting brackets transfer to second wheelchair = \$150

Mounting brackets transfer to second wheelchair bariatric = \$150

Lunar Swingaway Lateral = \$200

**(16) FRONT RIGGING**

<input type="checkbox"/>	70 Degree Pin Style -----	115FR01	Standard
<input type="checkbox"/>	80 Degree Pin Style -----	115FR02	\$135
<input type="checkbox"/>	60 Degree Swingaway Upgraded -----	115FR03	\$215
<input type="checkbox"/>	70 Degree Swingaway Upgraded -----	115FR04	\$215
<input type="checkbox"/>	90 Degree Swingaway Upgraded -----	115FR05	\$230
<input type="checkbox"/>	60 Degree Dual Swingaway Upgraded -----	115FR06	\$230
<input type="checkbox"/>	70 Degree Dual Swingaway Upgraded -----	115FR07	\$230
<input type="checkbox"/>	80 Degree Dual Swingaway Upgraded -----	115FR08	\$230
<input type="checkbox"/>	90 Degree Dual Swingaway Upgraded -----	115FR09	\$230
H <input type="checkbox"/>	Elevating Legrest (pair) -----	115FR10	\$550
H <input type="checkbox"/>	Dual Swingaway Elevating Legrest (pair) -----	115FR25	\$580
<input type="checkbox"/>	Omit Front Rigging -----	115FR11	less net \$20
<input type="checkbox"/>	Omit Footrest Hanger -----	115FR12	less net \$10

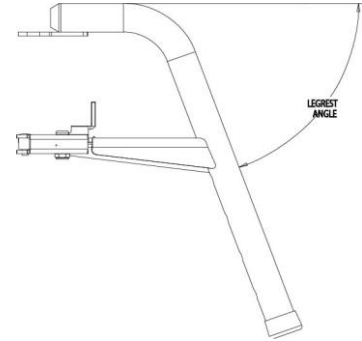

**(17) FOOTPLATE TYPE**

<input type="checkbox"/>	Composite Flip Up Footplates Small-----	115FP01	No Charge
<input type="checkbox"/>	Composite Flip Up Footplates Large-----	115FP02	No Charge
<input type="checkbox"/>	Aluminum Flip Up Footplates Medium-----	115FP05	Standard
<input type="checkbox"/>	Aluminum Flip Up Footplates Large-----	115FP06	Standard
<input type="checkbox"/>	Composite Angle Adj. Flip-Up Footplates Small -----	115FP08	\$120
<input type="checkbox"/>	Composite Angle Adj. Flip-Up Footplates Medium -----	115FP09	\$120
<input type="checkbox"/>	Composite Angle Adj. Flip-Up Cone Lock Large-----	115FP16	\$150
<input type="checkbox"/>	Composite Angle Adj. Flip-Up Cone Lock X-Large-----	115FP17	\$170
<input type="checkbox"/>	Aluminum Angle Adj. Flip Up Footplates Medium-----	115FP11	No Charge
<input type="checkbox"/>	Aluminum Angle Adj. Flip Up Footplates Large-----	115FP12	No Charge
<input type="checkbox"/>	Composite Angle Adj. Flip-Up Footplates Spring Return Lg-----	115FP04	\$150
I <input type="checkbox"/>	One Piece Footboard (15"-20")-----	115FP19	\$160
I <input type="checkbox"/>	One Piece Footboard (21"-24" Custom)-----	115FP20	\$195
<input type="checkbox"/>	Aluminum Angle Adj. Flip Up Footplates Small-----	115FP10	No Charge

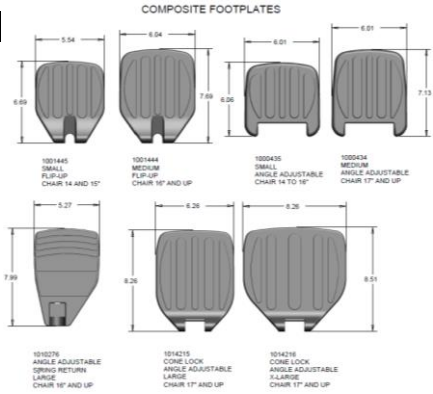

**(18) FOOTREST /LEGREST ACCESSORIES**

<input type="checkbox"/>	Heel Loops -----	115FA01	Standard
<input type="checkbox"/>	Omit Heel Loops -----	115FA02	less net \$7
<input type="checkbox"/>	Padded Calf Strap -----	115FA03	\$70
A1 <input type="checkbox"/>	Foam Guard on Elevating Legrest (pair) -----	115FA05	\$70
A1 <input type="checkbox"/>	Foam Pad One Piece Footboard -----	115FA06	\$50
A1 <input type="checkbox"/>	Foam Pad on Footplate (pair) -----	115FA07	\$70

**(19) WHEEL LOCKS**

<input type="checkbox"/>	Push-to-Lock Wheel Lock -----	115WL1	Standard
<input type="checkbox"/>	Pull-to-Lock Wheel Lock -----	115WL2	No Charge
<input type="checkbox"/>	Wheel Lock Extension -----	115WL3	No Charge

**(20) HEADREST HARDWARE OPTIONS**

<input type="checkbox"/>	Fixed Headrest Hardware -----	115HE01	No Charge
<input type="checkbox"/>	Fixed Headrest Curved Hardware -----	115HE15	No Charge
<input type="checkbox"/>	Fixed Headrest Hardware (Plus 4") -----	115HE02	\$20
<input type="checkbox"/>	Fixed Headrest Curved Hardware (Plus 4") -----	115HE16	\$20

**(21) HEADREST FOAM PAD OPTIONS**

<input type="checkbox"/>	Small Headrest Foam Pad -----	115HF1	No Charge
A1 <input type="checkbox"/>	Small Headrest with Wings Foam Pad -----	115HF2	\$90
<input type="checkbox"/>	Medium Headrest Foam Pad -----	115HF7	No Charge
A1 <input type="checkbox"/>	Medium Headrest with Wings Foam Pad -----	115HF8	\$90
<input type="checkbox"/>	Large Headrest Foam Pad -----	115HF3	Standard
A1 <input type="checkbox"/>	Large Headrest with Wings Foam Pad -----	115HF4	\$95

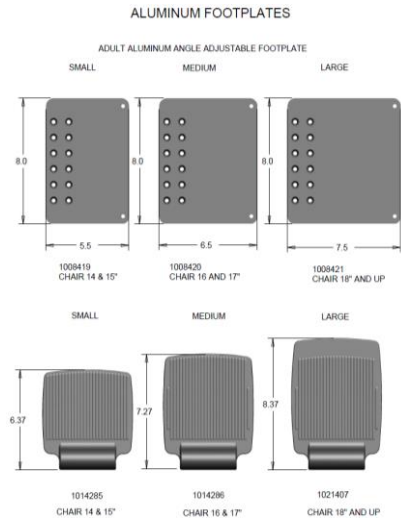

**FOOTNOTES:**

H. Includes Swingway Calf Pads  
I. Not available with 7" or 8" casters when footboard is facing back on 90 degree

**AADL # W324**  
**ORDER FORM**

A1	<input type="checkbox"/> Pro-Fit Small Headrest -----	115HF12	\$100
A1	<input type="checkbox"/> Pro-Fit Medium Headrest -----	115HF13	\$105
A1	<input type="checkbox"/> Pro-Fit Large Headrest -----	115HF14	\$110
	<input type="checkbox"/> Omit Headrest -----	115HE09	less net \$10

swingaway

**A1 = Clients Responsibility**  
**A2 = Clinical Justification**

**② HEADREST ADAPTOR BRACKETS**

	<input type="checkbox"/> 2 - Hole Headrest Adaptor Bracket with Clamp -----	115HEBA2	No Charge
A1	<input type="checkbox"/> Universal Headrest Adaptor Bracket with Clamp -----	115HEBA	\$61

**② ANTI TIP**

	<input type="checkbox"/> Quick Flip Anti-Tippers -----	115MA23	Standard
	<input type="checkbox"/> Fixed Anti-Tipper -----	115MA22	No Charge

**② MISCELLANEOUS ACCESSORIES**

	<input type="checkbox"/> Tilt Locking Collar -----	115MA01	\$20
	<input type="checkbox"/> Recline Locking Collar -----	115MA02	\$20
	<input type="checkbox"/> Auto Seat Positioning Strap -----	115MA03	\$52
	<input type="checkbox"/> Padded Lap Tray 15"-16" -----	115MA09	\$285
	<input type="checkbox"/> Padded Lap Tray 17"-18" -----	115MA10	\$285
	<input type="checkbox"/> Padded Lap Tray 19"-20" -----	115MA11	\$285
	<input type="checkbox"/> Padded Lap Tray 21"-22" -----	115MA12	\$385
	<input type="checkbox"/> Padded Lap Tray 23"-24" -----	115MA13	\$385
	<input type="checkbox"/> Half Padded Lap Tray, left side-----	115MA14	\$160
	<input type="checkbox"/> Half Padded Lap Tray, right side-----	115MA15	\$160
A1	<input type="checkbox"/> Elbow Stop, left -----	115MA16	\$55
A1	<input type="checkbox"/> Elbow Stop, right -----	115MA17	\$55
K A1	<input type="checkbox"/> Shoulder Lateral Pad (each) -----	115MA18	\$90
L A1	<input type="checkbox"/> Adjustable Side Pad -----	115MA19	\$157
A1	<input type="checkbox"/> IV Pole, telescopic-----	115MA20	\$168
A1	<input type="checkbox"/> Oxygen Tank Holder-----	115MA21	\$173
A1	<input type="checkbox"/> Quick Release Axle -----	115AL1	\$110
A1	<input type="checkbox"/> Spoke Guards available on 20", 22" and 24" wheels-----	115MA49	\$130
N A1	<input type="checkbox"/> Orion II Front and Rear Transit Hooks-----	115MA30	\$250
M A1	<input type="checkbox"/> Power Tilt -----	115MA31	\$1,600

**A1 = Clients Responsibility**  
**A2 = Clinical Justification**

**FOOTNOTES:**

K. Only available with Stroller Bar push option.

L. Not available with Flip Back Arms

M. Weight Capacity of Orion II with Power Tilt is 250 lbs. Power Tilt can only be placed on

Orion II chairs with seat width of 15" to 20"

Power Tilt provides approximately 42

degrees of infinite tilt (3° to 45°)

Includes: 2 Button Hand Control,

N. Transit Hooks can only be used on

Orion II wheelchairs up to 350 lbs. weight

capacity. Tested in accordance with

ANSI/RESNA WC/19

27V Plugin Battery Charger,

24V Battery/Control Box,

Compact Actuator with 135 mm

(5.31") Stroke Length

WARRANTY
Future Mobility Healthcare warrants the Orion II to be free from defects in materials and workmanship for a period of one (1) year from the date of purchase. The frame is warranted for the lifetime of the original purchaser and/or user. The batteries required for Power Tilt are warranted for six (6) months while the control box, battery charger, actuator and hand control are warranted for one (1) year.

\* Options marked by an asterisk are not covered by AADL and are the client's financial responsibility.

**AADL # W324**  
**ORDER FORM**